

**NORTH CHARLESTON
COLISEUM**

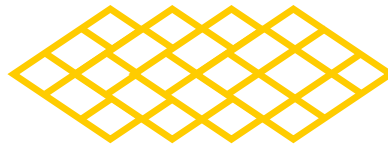

**NORTH CHARLESTON
PERFORMING ARTS CENTER**

CHARLESTON AREA CONVENTION CENTER

R. Keith Summey
Mayor

David R. Holscher
General Manager

FACILITY USER GUIDE

FOR THE

*North Charleston Coliseum
North Charleston Performing Arts Center
Charleston Area Convention Center*

REVISED JANUARY 2012



Private Management for Public Facilities

TABLE OF CONTENTS

1.0	FACILITY CONTACTS	4
2.0	RENTAL POLICIES	5
2.1	LICENSE AGREEMENT	5
2.2	RENTAL FEES	5
2.3	INSURANCE	6
2.4	MARKETING	6
2.5	NOVELTY SALES	6
3.0	TICKETING.....	7
4.0	RATE SHEETS	8
4.1	EQUIPMENT RATES:	8
4.2	SERVICE RATES:	8
4.3	LABOR RATES	9
4.4	STAGEHAND RATES	9
5.0	GENERAL PROVISIONS	10
5.1	ABANDONED PROPERTY.....	10
5.2	ACCOMMODATIONS FOR GUESTS WITH DISABILITIES	10
5.3	ADVERTISING.....	10
5.4	AIR CONDITIONING, HEATING AND LIGHTING	10
5.5	ANIMALS.....	10
5.6	AUDIO AND LIGHTING	11
5.7	CANCELLATION.....	11
5.8	CARPETED AREAS	11
5.9	COPYRIGHT FEES	11
5.10	DAMAGE & CLEAN-UP.....	11
5.11	DISCRIMINATION	11
5.12	ELECTRICITY, AIR, WATER, TELEPHONE OR OTHER UTILITIES.....	11
5.13	ELEVATORS.....	11
5.14	ENTRANCES/EXITS	12
5.15	EVENT PERSONNEL	12
5.16	EXCLUSIVE SERVICES	12
5.17	FOG/SMOKE MACHINES	12
5.18	FREIGHT DELIVERIES	12
5.19	GRATUITIES.....	12
5.20	HAZARDOUS CHEMICALS AND MATERIALS.....	12
5.21	KEYS AND LOCK CHANGES	12
5.22	LICENSEE’S PROPERTY.....	13
5.23	MEDICAL SERVICES	13
5.24	NOISE.....	13
5.25	PARKING	13
5.26	PERMITS.....	13
5.27	RECYCLING	13

- 5.28 RENTAL OF EQUIPMENT 13
- 5.29 RESIDUAL MATTERS 13
- 5.30 RIGGING SERVICES..... 14
- 5.31 SAFETY RAIL..... 14
- 5.32 SECURITY..... 14
- 5.33 SIGNS, DECORATIONS AND BALLOONS..... 14
- 5.34 SMOKING 14
- 5.35 TAPE AND DECALS..... 14
- 5.36 WEAPONS 14

- 6.0 GENERAL GUEST POLICIES15**

- 7.0 FIRE & LIFE SAFETY STANDARDS16**

- 8.0 FOOD & BEVERAGE.....18**
 - 8.1 EXCLUSIVE SERVICES 18
 - 8.2 MENUS & FOOD 18
 - 8.3 SAMPLING GUIDELINES 18
 - 8.4 ALCOHOLIC BEVERAGES 19
 - 8.5 HOSPITALITY CATERING 19
 - 8.6 CONCESSION STANDS..... 19
 - 8.7 FYI 19

- 9.0 DIRECTIONS20**

- 10.0 SERVICE CONTACTS21**

- 11.0 FACILITY DIAGRAM.....24**

- 12.0 EXHIBITOR FOOD BOOTH PERMIT APPLICATION25**

- 13.0 MARQUEE MESSAGE REQUEST FORM.....27**

FACILITY-SPECIFIC INFORMATION *(Available upon request)*

NORTH CHARLESTON COLISEUM

NORTH CHARLESTON PERFORMING ARTS CENTER

CHARLESTON AREA CONVENTION CENTER

1.0 FACILITY CONTACTS

SMG

Administration	Fax: (843) 529-5010	
Dave Holscher	General Manager	5002
John Trinkl	Assistant General Manger	5003
Tina Johnson	Executive Assistant	5001
Jenna Rickoff	Catering Sales Mgr./Suites	5029
Receptionist	529-5050	0

Finance		
Ronnie Burkett	Finance Director	5004
Tina Johnson	Payroll/Benefits Coordinator	5005
Pam Harris	Accounting Technician	5031

Convention Center	Fax: (843) 529-5040	
Ed Riggs	Director of Sales	5011

Ticketing/Group Sales	Fax: (843) 529-5030	
Mike Ziemnick	Ticket Office Manager	5006
Allison Thompson	Asst. Ticket Office Mgr.	5007
Christie Owen	Asst. Ticket Office Mgr.	5008

Marketing / Novelties	Fax: (843) 529-5060	
Alan Coker	Marketing Manager	5012
Melanie Crowley	Marketing Coordinator	5035

Operations	Fax: (843) 529-5060	
Wes Dickerson	Director of Operations	5036
Luana Sievert-Rivera	Operations Coordinator	5032
	CACC Service Desk	5026
Alex Pridgen	Event Manager	5013
Amy Robb	Event Coordinator	5048
Charlie Harris	Senior Event Staff Supervisor	5014
Darbis Briggman	Senior Event Staff Supervisor	5014
Arron Bryant	Change-Over Manager	5015
Elliott Bowman	Asst. Change-Over Manager	5015
Mac Mayes	Custodial Manager	5016
Andy York	Command Center Manager	5017
David Swain	Technical Director	5037
Artie Ortiz	Telecomm Supervisor	5034
Debbie Sandefur	Network/Computer Technician	5038
Jeff Litchenberg	IT/Operations Technician	5047
Mike Coffey	Coliseum Union Crew Chief	5019
Chris Russell	PAC Union Crew Chief	5018
Caleatha Bowens	Custodial Event Asst. Manager	
Patricia Hajek	Day Custodian	5127

CENTERPLATE

Main Telephone: (843) 744-0168 Fax:(843) 566-1731

Staff		
Rich Kellstrom	General Manager	4900
Steve Dottai	Executive Chef	4903
JoWanda Hill-Aiken	Office Manager	4901
Jason Torrance	Operations Manager	
Jeanette Smalls	Catering Manager	4904
Tom Veneziano	Event Manager	4907
	Warehouse	4906

FACILITY PARKING

Main Telephone: (843) 554-3887 Fax:(843) 554-3406

Staff		
Mark Cruse	Facility Parking Mgr.	
Chris Grammer	Event Parking Manager	

INFORMATION NUMBERS

Event Information Line	(843) 529-5000	
PAC Season Tickets	(843) 202-ARTS	2787
Ticket Information		5113
Disabled Information	(843) 529-5033	
TDD Coliseum	(843) 529-5021	
TDD Conv. Ctr.	(843) 529-5022	
First Aid Coliseum		5054
First Aid Convention Ctr.		5055
Command Center Coliseum		5051
Command Center PAC		5052
Command Center Conv. Ctr.		5053
Guest Services		5041

Building Services	Fax: (843) 529-5084	
Rick Comps	Building Services Manager	5028
Larry Cheslek	Electrical Supervisor	5027
Rodney Frock	Mechanical Supervisor	5024
Henry Hill	Maintenance Technician	5023
Dennis Foote	Event Technician	5042

2.0 RENTAL POLICIES

2.1 LICENSE AGREEMENT

Requests for the license of space at the North Charleston Coliseum, Charleston Area Convention Center and Performing Arts Center (the Facilities) must be made in writing, stating the date(s) of the event, space required, time(s) of use and the legal name of the potential user. Tentative reservations will be held ten working days, pending receipt of a written confirmation.

A license agreement outlining deposit, insurance and other pertinent requirements will be issued after receipt of confirmation. The agreement must be fully executed and returned with the required deposit within the specified time period to secure date(s) and space. The Facilities require an executed license agreement prior to release of service order forms.

2.2 RENTAL FEES

The amounts and/or percentage of minimum rent that will be paid to the Facilities are as follows:

COLISEUM 180° / 270° / 360° configurations	13,000 seats	\$7,500 vs. 15% of net ticket sales OR \$20,000 for non-ticketed or non-Ticketmaster event
HALF - COLISEUM	3,000 – 6,500 seats	\$5,000 vs. 15% of net ticket sales OR \$15,000 for non-ticketed or non-Ticketmaster event
PERFORMING ARTS CENTER	2,341 seats	\$3,500 vs. 15% of net ticket sales OR \$10,000 for non-ticketed or non-Ticketmaster event OR \$15,000 for non-ticketed or non-Ticketmaster event on Fridays/Saturdays, October 1-May 1
NOTE: Net ticket sales are gross receipts minus 5% state admissions tax		

EXHIBIT HALL	SQUARE FEET	RATE (PER DAY)
A1	15,340	\$3,500
A2	11,700	\$2,000
A Combined	27,040	\$5,000
B	24,960	\$4,000
C	24,960	\$4,000
A/B Combined	52,000	\$8,500
B/C Combined	49,920	\$7,500
A/B/C Combined	79,960	\$12,000
NOTE: Move-in/Move-out is 50% of rate per day up to 2 days, 100% of rate for additional days		

2.2 RENTAL FEES (CONT)

Rates include ordinary lighting, air conditioning and/or heat. Charges for all necessary labor, equipment, utilities, set-up and clean-up are in addition to the standard rental rate and are shown on the following rate sheets.

All payments must be in U.S. funds by cash, check or bank wire. Payments may be required in the form of cashier's check, money order or bank wire.

If deemed necessary by the General Manager, 100% of the rental or other fees are due and payable in advance of use of the Facilities. The General Manager may require a security deposit and/or bond in the amount equal to the risk and expense involved with any event.

All payments will be non-refundable in the event of cancellation by Licensee, and the Facilities may pursue its remedies as provided in the license agreement.

For events where ticket monies are collected by the Facilities' ticket office, payment for rental, expenses and taxes will be deducted from the ticket office receipts before the balance, if any, is transferred to the Licensee.

Should ticket sales be insufficient to cover rental and expenses, Licensee may be required to pay additional deposits, prior to the event, equal to the estimated total expenses. The payment, if required, must be made by cash, bank wire, cashiers check or money order.

2.3 INSURANCE

A Certificate of Insurance needs to be provided to the Facilities at least two weeks prior to the event (a minimum of \$2,000,000). It will be purchased by us as an additional expense to you, if not received at least two weeks prior to the event. Please note that the Charleston Area Convention Center Complex, SMG, the City of North Charleston and its employees must be listed as additional insured's.

2.4 MARKETING

Our Marketing staff can assist in advertising, promoting and over-all marketing of your event. This department operates as a full-service, in-house advertising agency at negotiated rates to the user. Services include advertising placement, negotiation and settlement; public relations services; group sales and sponsorship sales. Space is available for advertising in the public areas of the Facilities. Marketing information and service fees are available from the Marketing Manager upon request. *It is highly recommended that you ask for an overview of the market and discuss marketing strategies with the Marketing staff prior to the start of any media campaign, whether utilizing the Marketing Department or implementing the campaign yourself.*

2.5 NOVELTY SALES

The Facilities retains 35% of net novelty/ merchandise sales. Net sales are gross receipts minus 8.5% state and local sales taxes. Sales are on a cash basis. Credit card sales are available at a cost to the event of 3.5% of credit card sales.

Novelties should be advanced with the Novelties Sales Manager at least 7 days before the scheduled event. The Facilities uses its own novelty/merchandise sellers and is responsible for compensating said sellers.

Security for bootleg t-shirt patrol requires off-duty members of the North Charleston Police Department only. Please arrange this service through your Event Coordinator.

3.0 TICKETING

The standard ticketing charges that will be paid to the Facilities are as follows:

Convention Center

Ticketing charge for “day of” exhibit hall ticket sales are \$500.00 set-up fee plus .50 per ticket, 3% credit card sales and reimbursement for all labor.

Coliseum & Performing Arts Center

Credit card sales: 3%.

Group sales: 10% of all group ticket sales, plus actual expenses incurred.

Capital Facilities Fee: The City of North Charleston assesses an additional charge of \$1.00 per paid ticket, which is incorporated into the price of each ticket and is taken off the top at settlement.

State Admissions Tax: A 5% State Admissions tax is taken out of the gross ticket sales.

Promotional Tickets State Admissions Tax: A 5% State tax is taken on all comp tickets used for promotional trade purchases.

Ticketmaster Carolinas provides ticketing services. Ticketmaster provides purchasers the option of buying tickets via phone, Internet, Outlets or the Coliseum ticket office. This vast network permits consumers to purchase tickets 24 hours a day, 365 days a year.

Convenience charges are assessed against ticket purchasers made via the ticketing system. The fee structure for convenience charges is available upon request.

Phone Center Information/Internet Sales

800-745-3000
9 a.m. - 5 p.m. Monday - Saturday
Closed Sunday

Tickets may be purchased on line at www.ticketmaster.com.

Advance Ticketing Hours

Advance ticketing is temporarily located at the Performing Arts Center ticket window.

10:00 a.m. to 5:00 p.m., Monday – Friday with the following exceptions:

- Open on Saturday at 10:00 a.m. for scheduled events
- Open on Sundays at 12:00 noon for scheduled events
- Open on Saturday at 10:00 a.m. for scheduled on-sales

Coliseum Day of Show Hours

10:00 a.m. until promoter closes, Monday – Saturday
12:00 noon until promoter closes, Sundays

Two hours prior to show until promoter closes
(North and South Lobbies)

Performing Arts Center Day of Show Hours

Two hours prior to show until promoter closes
(Exterior windows at SW corner of PAC)

Outlet Locations (Hours vary upon location)

Statewide

Select Publix Grocery Stores

For a detailed list of outlet locations, please call Mike Ziemnick at 843-529-5006 or go to our website at <http://www.northcharlestoncoliseum.com/>.

4.0 RATE SHEETS

4.1 EQUIPMENT RATES:

Stage (incls. steps, handrail & skirting)	\$250 (per day)
Risers	\$5 (each)
Stage Barricade	\$150 (per day)
Crowd Control Barricade	\$10 (per section)
Backdrop drape (20'x40')	\$150 (each, 5 available)
Sound System	\$500 (per day plus labor)
Microphones	\$25 (each per day)
Intercom/Paging	\$50 (per day)
Spotlights	\$100 (each per day)
PAC Sound & Lights	\$2000 (per day plus labor)
Forklift (5,000 lb.)	\$150 (per day)
Man lift – Motorized	\$65 (per hour operator included)
- Manual	\$20 (per hour or \$100 per day)
Portable Basketball Floor	\$250 (per day)
Scoreboard	\$500 (per day plus labor)
Zamboni	\$250 (per day plus labor)
Furniture	Cost plus 10%
Podium	\$50 (per day)
Tables (unskirted)	\$10 (each per show)*
Chairs (quantity pricing available)	\$5 (each per show) fiberglass side chair*
	\$15 (each per show) padded chair*

*When used for exhibits

4.2 SERVICE RATES:

Set-up	\$1,000 (per event plus time worked on multi-day events)
Utilities	\$1,000 (per day)
Exhibit Hall Air Conditioning/Heat	\$500 (per load-in/out day)
Compactor (Exhibit Hall)	\$600 (per load)
TV Production	\$1,500 (per day)
Bus Power	\$50 (each per day)
20a Outlet	\$75 (each)
Telephone	\$200 (per line, advance order rate)
Internet Connection	\$350 (per connection, advance order rate)
Cable TV	\$50 (per day plus TV rental)
TV & VCR	\$75 (per day)
Facsimiles	\$1.00 (per page)
Photo Copies	\$0.25 (per page)
Piano rental (upright)	\$150 (incls. one tuning)
Piano Tuning	\$65 (per tuning)
Balloon Removal (Convention Center)	\$65 (per hour)
Trade Show Decorator	Cost plus 10% or 10% of your cost

Equipment/services are subject to availability
Rates are subject to change

4.3 LABOR RATES

(per hour - 3-hour minimum)

Supervisors	\$11.40
Ushers, Door Guards, Ticket Takers & Sellers	\$9.40
Telephone Operator	\$9.40
Event Change-Over	\$14.90
Event Cleaning	\$10.65
House Sound & Lights	\$19.50
Electrician	\$22.50
Peer Security	Cost plus 15%
Command Center Security	\$10.65
Risk Supervisor	\$12.40
Police or Fire Supervisor	\$26.50
Police or Fire	\$22.50
Medical Supervisor	\$26.50
Medical	\$22.50
Zamboni Driver	\$15.00
Scoreboard Operator	
Game Operations or Graphics	\$15.00

4.4 STAGEHAND RATES

(per hour, minimums apply) - IATSE Local 333

Crew Chief	\$25.26
Rigger	\$23.50
Equipment Operator	\$16.35
Stagehand	\$15.65
Loader	\$15.65
Performance (3.5 hr)	\$62.60
Crew Chief Performance (3.5 hr)	\$101.04

Stagehand Minimums

- 4-hour minimum on load-in calls
- Performance and rehearsals are billed at performance rate
- 3-hour minimum on all other calls

Stagehand Overtime

- One and one-half (1-1/2) times the base hourly rate is billed for the following:
 - a. Work in excess of 10 hours in one day or 40 hours in one week
 - b. Midnight to 8:00 AM
 - c. Performance and rehearsal calls that run longer than 3.5 hours
 - d. Meal penalty after 5 hours - meal options are: 1) a 1/2-hour meal provided, by the client, on the clock; or 2) a 1-hour break off the clock.
 - e. Holidays
- Calls canceled with less than 24-hour notice are billed a 4-hour cancellation charge

Labor & Stagehand rates are subject to an Administrative Fee
Rates are subject to change

5.0 GENERAL PROVISIONS

5.1 ABANDONED PROPERTY

Any property not removed from the Facilities that has not been claimed within 48 hours following the end of the license agreement will be considered abandoned by Licensee. The Facilities may take possession of it and treat it as its own or dispose of such property without liability. The Licensee shall be liable for the cost incurred in disposing of the abandoned property.

5.2 ACCOMMODATIONS FOR GUESTS WITH DISABILITIES

The Facilities makes every effort to be accessible to guests with disabilities. There is accessible parking at the Facilities. Wheelchairs, assisted listening devices, TDD telephones and other accommodations are also available.

Concerning the Americans with Disabilities Act and all regulations hereunder, the Facilities will be responsible for the permanent premises access accommodations such as, but not limited to: wheelchair ramps, elevator standards, door width standards and rest room accessibility. The Licensee will be responsible for nonpermanent accessibility requirements such as, but not limited to: auxiliary aids for the visually impaired, hearing impaired and mobility impaired, general seating arrangements and event accessibility.

If Licensee fails to arrange for a reasonably-requested temporary auxiliary aid or service, the Facilities will have the right, but not the obligation, to provide or arrange for such temporary auxiliary aid or service, and the Licensee will reimburse the Facilities the cost of providing or arranging for such temporary auxiliary aid or service as determined by the Facilities.

The Licensee must also indemnify and hold harmless the Facilities and the City of North Charleston, their agents, employees, servants and officials from any and all claims, losses, damages or expenses, including reasonable attorney's fees, arising out of or resulting from the Licensee's failure, or the failure of any of your agents, employees, servants, exhibitors, performers and officials, to comply with the ADA or applicable regulations.

5.3 ADVERTISING

The Marketing staff can assist in the advertising and promotion of your event. This department operates as a full-service, in-house advertising agency at negotiated rates to the Licensee. Services include advertising placement, negotiation and settlement; public relations services; group sales and sponsorship sales. Space is available for advertising in the public areas of the Facilities.

Licensee must not advertise any event unless and until contracts between all parties have been fully executed. Fees will be charged, and Licensee must make contractual arrangements with the Facilities prior to using any marketing service.

5.4 AIR CONDITIONING, HEATING AND LIGHTING

Air conditioning and/or heating are provided complimentary during event hours. Air conditioning and/or heating may be provided on move-in or move-out days at an additional cost. Requests for air conditioning and/or heating during non-event periods or during registration periods other than actual event hours will be charged at the prevailing rate.

Twenty-five percent (25%) lighting will be provided during move-in and move-out. One hundred percent (100%) lighting will be provided only during event hours beginning sixty (60) minutes prior to event opening on first day and thirty (30) minutes prior to opening on subsequent days.

5.5 ANIMALS

No animals are permitted in the Facilities unless the animal is: (i) a service animal (Seeing Eye dog, etc.) or (ii) part of a show or exhibit, and only if the animal is on a leash, in a pen or cage or is under similar control by the animal's owner. The Facilities must pre-approve animals that are part of a show or exhibit.

5.6 AUDIO AND LIGHTING

Audio and lighting services are available through the Facilities. Audio and lighting equipment, operator rates and the operating policies governing the use of these services are outlined on separate service order forms. Services of a preferred “in-house” audio/visual production contractor are available through the Facilities upon request.

5.7 CANCELLATION

Cancellation of an event must follow guidelines established by the Facilities, including ticket refund procedures and notification of the public.

5.8 CARPETED AREAS

Generally, during move-in and move-out, the carpeted areas must be protected from the movement of crates, registration counters, pallet jacks, sign-making activities and all other rolling stock. This may be accomplished by the use of reinforced visqueen. In the case of heavy freight, the use of plywood or other similar material may be required. Licensee will consult with the Facilities to review the required procedures.

5.9 COPYRIGHT FEES

Licensee warrants that no music or artistic work or other property protected by copyright will be performed, produced, exhibited or used, nor will the name of any entity protected by trademark be reproduced, exhibited or used during Licensee’s use of the Facilities, unless Licensee has obtained expressed written permission and license from the copyright or trademark holder. Licensee covenants to comply strictly with all laws respecting copyright and trademarks and warrants that it will not infringe any related statutory, common law or other rights of any person during its use of the Facilities.

Licensee is responsible for remitting payment to appropriate agencies for use of copyrighted materials. Licensee will indemnify and hold the Facilities and its officers, agents and employees harmless from all liability, costs and claims, losses and/or damages (including court costs and attorney’s fees) with respect to such copyright or trademark right.

5.10 DAMAGE & CLEAN-UP

Damage and/or clean up fees for all users are clearly established as part of the license agreement. An estimated amount for damages or clean up may be withheld from settlement pending the determination of actual costs.

5.11 DISCRIMINATION

A Licensee conducting an event open to the public will not discriminate against any person because of sex, race, color, religion, ancestry, national origin or disability. The Licensee will not directly or indirectly display, circulate, publicize or mail any advertisement, notice or communication which states or implies that any facility or service will be refused or restricted due to discrimination.

5.12 ELECTRICITY, AIR, WATER, TELEPHONE OR OTHER UTILITIES

The Facilities provide utilities as an exclusive service. Electric, air, water and drainage, telephone and Internet (including wireless) service rates are outlined on separate service order forms. Operating policies governing the use of these services are listed on the respective service order forms.

All electrical equipment must be Underwriter Laboratory approved. All gas operating equipment must be approved, and the required permits and/or approvals must be obtained from the North Charleston Fire Department.

The Facilities’ electrical equipment (e.g., electrical cords, electrical distribution panels, spotlights, etc.) is not to be removed by the exhibitors, service contractors or other personnel.

5.13 ELEVATORS

Passenger elevators are provided for use by the general public and must not be blocked or used to transport equipment or freight.

An elevator operator may be required when utilizing the Facilities’ freight elevators. The freight elevators should not be for general public use.

5.14 ENTRANCES/EXITS

In compliance with N.F.P.A. Life Safety Code 101, the Licensee must not: (i) obstruct any entrances or exits in the Facilities; (ii) obstruct any stairways, hallways or access within the Facilities; (iii) obstruct any sidewalks or roadways outside the Facilities or (iv) block, prop open or alter any doors in any way.

The entrances of the Facilities must not be used for loading or unloading purposes.

5.15 EVENT PERSONNEL

Event staffing is available at the prevailing rate for the following categories: security guards, ticket sellers, ticket takers, ushers, electricians, technicians, labor personnel for set-up of Facilities equipment and other similar categories of personnel as listed under Section 4.3 Labor Rates. Event staffing is an exclusive service of the Facilities.

Determination of the number of personnel and the hours worked by the various categories will be at the discretion of the General Manager after consultation with Licensee. All other persons employed by Licensee or affiliated with any event that takes place in the Facilities will be the responsibility of the Licensee. Event personnel rates are outlined on a separate rate schedule.

Individuals working in the Facilities must wear an approved identification badge provided by their respective employer or obtained from the Facilities' security office.

5.16 EXCLUSIVE SERVICES

The Facilities is the exclusive provider of the following services: Audio/Visual; Event Staffing; Food & Beverage; Novelty and Program Sales; Parking; Business Center (providing photocopying, facsimile services and computer rental); Rigging; Telecommunications and Internet (including wireless); Utility Services (including electrical, plumbing, compressed gases and any other utilities required for any purpose related to the event).

5.17 FOG/SMOKE MACHINES

Fog/smoke machine usage is restricted to water-based chemicals. Approval must be obtained from the Facilities' Event Services Department.

5.18 FREIGHT DELIVERIES

Freight and C.O.D. deliveries (including, but not limited to, UPS, FedEx, RPS, etc.) will not be accepted by the Facilities. Shipments delivered to the Facilities, during the term of the license agreement, will be to the attention of the Licensee and/or Contractor. Shipments delivered prior to license dates will be refused.

5.19 GRATUITIES

Facilities policy prohibits any Facilities employee from accepting gifts, gratuities or any other favors from parties doing business with the Facilities pursuant to the SMG Business Conduct Policy.

5.20 HAZARDOUS CHEMICALS AND MATERIALS

The Licensee will not bring upon the Facilities any exhibit, equipment or vehicle which, in the judgment of the Facilities, would be or might be dangerous to persons or property or otherwise incompatible with the structure, systems and furnishings. Hazardous chemicals and materials; e.g., pesticides, herbicides, poisons, etc. are prohibited inside the Facilities. The Licensee is responsible for removal of hazardous waste and must comply with all applicable federal and local regulations. Hazardous waste includes materials that are ignitable, corrosive, reactive, and toxic or biohazard (as defined less than 40 CFR 261 subpart C and D). Any costs or applicable administrative expenses incurred by the Facilities for the removal of hazardous waste left in or about the Facilities will be assessed to the Licensee.

Gasoline, kerosene, diesel fuel or other flammable liquids must not be stored in the Facilities.

5.21 KEYS AND LOCK CHANGES

Keys are available, and locks can be changed for some rooms. Requests for keys should be made through the Building Services Department, and all keys must be returned on the last day of the event. Five keys per room will be issued at no charge. Additional keys will be charged at the prevailing rate. Charges for lock changes and keys not returned will be charged at the prevailing rate.

5.22 LICENSEE'S PROPERTY

The Licensee assumes full responsibility to safeguard all property owned or used by the Licensee, within the contracted areas, from the beginning of the license period until move-out is complete.

5.23 MEDICAL SERVICES

Medical services are recommended for all events. Arrangements for proper coverage can be made through the Facilities. A First Aid room is available for use at no additional charge.

Labor will be additional expense to event at the prevailing rate. The Facilities have the right to impose this labor as deemed fit for security/safety matters.

5.24 NOISE

In order to insure successful events for all users of the facility, the Facilities' reserves the right to adjust the volume of any audio-visual equipment. Noise is:

That, by reason of its level, nature, character or quality, or the time at which it is made, or any other circumstances:

(i) is harmful to (or is likely to be harmful to) a person who is outside the premises from which it is emitted, or

(ii) interferes unreasonably with (or is likely to interfere unreasonably with) the comfort or repose of a person who is outside the premises from which it is emitted

5.25 PARKING

The Facilities charges a parking fee to all users of its parking areas at the prevailing rate on event days. Overnight parking on the property is prohibited unless approved by the Facilities. Exhibits must not be placed outside the Facilities or in any parking areas unless that area has been contracted as exhibit space.

Parking in the loading dock areas or inside any building (except for loading or unloading) is prohibited. Violators' vehicles are towed at the owners' expense.

5.26 PERMITS

Special permits may be required (e.g., for cooking, pyrotechnic, tents, multi-level or covered exhibits and/or other potentially hazardous situations). Each situation must be individually approved. Permit information may be obtained by contacting the Facilities' Event Services Department.

Cooking permits must be obtained from the North Charleston Fire Department. A 2A40 B.C. or K class fire extinguisher must be in the booth, no more than 30 feet from each device used for cooking. Licensee must comply with all Health Department rules and regulations. Bottled gas may be used, during event hours only, for cooking or demonstration purposes using day tanks (see page 16, item 14 for additional information). Tanks must be removed from the Facilities daily at the close of event. At no time can tanks be stored in the Facilities.

Events involving cooking or food preparation must provide an appropriate number of utensil clean-up areas. Disposal of cooking residue into the Facilities' drainage system is prohibited. Licensee will provide holding tanks for disposal of cooking residue (oil, grease, etc.).

Multi-level or Covered Exhibits Guidelines are available through the Event Services Department. Automatic extinguishing systems or fire watch personnel are required. Licensee will be charged for fire watch personnel per the rate schedule.

5.27 RECYCLING

The Facilities participates in the Charleston County recycling program. A separate, specially marked compactor or container is dedicated for cardboard only. Licensee should not put any other type of material in the compactor that would contaminate the contents including, but not limited to, wooden materials, wooden pallets, cement block, carpet, padding or hazardous materials.

Bulk and irregular waste will be placed only in open-top dumpsters. Waste will not extend beyond the sides of the dumpsters.

5.28 RENTAL OF EQUIPMENT

Rental equipment and the prevailing rates are listed on a separate rate schedule. Facilities equipment must be set up and operated by authorized Facilities personnel. Tables and chairs, when used for exhibits, will be charged at the prevailing rates. Labor charges for operators will be in addition to the rental charge for equipment.

5.29 RESIDUAL MATTERS

The General Manager of the Facilities will determine any matters not expressly covered by the Facility User Guide. The Facilities reserves the right to alter and/or amend this Guide.

5.30 RIGGING SERVICES

Production and exhibitor rigging is an exclusive service that must be supervised and installed by the Facilities. Approval is required for rigging locations in public areas, subject to multiple-event requirements. Approval of on-site rigging requests or changes is subject to availability of personnel.

Specific rigging guidelines are provided through the Facilities Operations Department. Requests and rigging plot diagrams should be submitted for approval a minimum of 4 weeks in advance of the event. The Facilities may prohibit the installation of any item(s) not approved in advance or not in compliance with the approved request for rigging. All rigging must comply with appropriate Federal and State regulations.

5.31 SAFETY RAIL

All performance stages and meeting room risers that are not positioned flush against a back wall must be equipped with safety railing. Licensee is required to sign a waiver of liability should they request the removal of the railing.

5.32 SECURITY

A minimum level of security personnel is required for all events. Security levels for non-public events (conventions, trade shows) are determined jointly by the Licensee and the Facilities' representative. Security levels for consumer and public ticketed events are determined by the Facilities. Door guards, badge checkers, security guards or off-duty police officers are used as needed. A copy of the Facilities Emergency Plan is available upon request.

5.33 SIGNS, DECORATIONS AND BALLOONS

Signs, decorations, banners, etc. must not be taped, nailed, tacked, stapled or otherwise fastened to ceilings, walls, doors, windows, painted surfaces or columns in any rooms, hallways or lobbies in the Facilities without permission. The Licensee will not mark, paint, drill into or in any way alter, mar or deface any part of the Facilities.

Helium balloons are not permitted within the Coliseum and Performing Arts Center. Balloons may be used in the Convention Center with advance notice. If necessary, a balloon removal fee will be assessed.

5.34 SMOKING

Smoking is not permitted inside any portion of the Facilities at any time. Smoking is restricted to outside the buildings only. The Licensee must cooperate with enforcing the no-smoking policy.

5.35 TAPE AND DECALS

Only professional double-sided carpet tape may be used on Center floor. Duct tape, clear "cellophane" or packing tape is specifically prohibited. Vinyl tape or chalk can be used to mark the floors.

Licensee and service contractors are responsible for the removal of all tape residue marks from the exhibition hall(s), concourse and meeting room floors. The use of high residue tape is prohibited on concrete floors and carpeted areas. Tape or residue left on any surface will be removed by the Center and the cost for removal will be billed to Licensee.

Adhesive-backed (stick-on) decals or similar items (except name tags or passes) must not be distributed or used in the Facilities.

5.36 WEAPONS

The carrying of firearms and/or other weapons of any kind within the Facilities (except for "officers of the law") is strictly prohibited.

6.0 GENERAL GUEST POLICIES

The following is a list of general guest policies that will be enforced. These policies should be upheld regardless of the type of event. Any change to these policies must be cleared through the Facilities.

1. Each guest (including children two years and older) entering the Facilities for any type of ticketed event must have a ticket or the proper event credentials. Guests who experience a problem with their tickets (i.e., lost or stolen tickets, etc.) should be directed to the Main Ticket Office.
2. Guests entering the Facilities for an event must enter through the lobbies, where a visual inspection may be conducted. Media personnel must enter through a designated press entrance.
3. Guests may not bring any bottles, cans, coolers or alcoholic beverages into the Facilities. Weapons of any kind (knives, guns, clubs, etc.) or any objects that may be used as weapons are also strictly prohibited from being brought into the Facilities. Anyone found carrying alcoholic beverages, a weapon or an item that may be used as a weapon will be brought to the immediate attention of a manager or uniformed officer.
4. Loitering in the lobbies is prohibited. Only those persons with the intent to attend the event or buy tickets to an event may stand in the lobby.
5. Ticket resale or attempted resale at a price more than one dollar (\$1.00) above the price appearing on the face of the ticket (scalping) on Facilities' property is a violation of South Carolina state law.
6. All guests must wear footwear. All males must wear a shirt and pants or shorts of some type. All females must wear a blouse, pants, skirt, shorts or dress. Deviations will be brought to the attention of a manager.
7. Everyone must sit/stand in the location that matches the seat, section, row and number that is on their ticket.
8. Only one person is allowed to occupy a chair at a time, except for children less than two.
9. Standing on chairs, sitting on seat backs and placing feet on chair backs is prohibited.
10. Standing in the aisles, accessible platforms, vomitories or other restricted areas while an event is in progress is prohibited.
11. Only guests 21 years of age or older may purchase alcoholic beverages. These people must show proper identification and get their wrist banded prior to purchasing alcoholic beverages.
12. Guests may not sell any type of food, candy, beverages, tobacco products, souvenirs, toys, programs or event ticket in or on the Facilities' property. Only concessionaires contracted by or through Centerplate may sell food in and on the Facilities' property. Each employee doing so must wear the proper identification while selling.
13. Any guest caught defacing, damaging or destroying property or grounds will be brought to the immediate attention of a manager or uniformed officer.
14. Guests may not bring into the Facilities any item that may be used to interfere or disrupt the event (I.E., noise makers, obscene or offensive signs, laser lights, etc.).

7.0 FIRE & LIFE SAFETY STANDARDS

North Charleston Fire Department

The guidelines listed below are general in nature and in no way relieve the Licensee and/or exhibitor or their representatives from complying with all applicable provisions of Federal, State and local fire and building codes. If you have any questions concerning these guidelines, please contact the North Charleston Fire Inspection Bureau at (843) 740-2617.

You may incur fees for the following services, if required, by the North Charleston Fire Department:

- a. Fire Watch
- b. Permit Fees
- c. After-hours site inspection (between the hours of 5:00 pm and 8:00 am)

Circumstances where fire watch, permit(s) or after-hours site inspections may be applicable, include, but are not limited to:

- a. Use of pyrotechnics
- b. Use of open flame
- c. Vehicles parked inside

General Requirements

1. Blocking of any Fire Exit is prohibited. Exit signs must remain visible.
2. No item or device will be hung from, or affixed to, any sprinkler head or piping.
3. Electrical installations must be in conformance with the National Electrical Code. All extension cords must have grounded plugs, must be UL listed, labeled and appropriately sized (we recommend using UL listed surge protectors). There must be no excessive use of extension cords.
4. Posted occupant loads must not be exceeded.
5. Display booths must be of either non-combustible material, fire retardant treated wood or any other materials fire treated in an approved manner.
6. Decorative materials, such as loose fibers, bark, curtains, hangings, table covers, etc. must be fire retardant treated in an approved manner.
7. The use of open flame, unless approved by this office, is prohibited.
8. Licensee must submit a plan showing all details of the event layout, including location and width of exit ways and aisles, for approval by the Fire Inspector. This plan must be submitted prior to move-in and include a contact name and phone number.

Plans should be forwarded to the North Charleston Fire Department, P.O. Box 190016, North Charleston, SC 29419-9016, and Attn: Chief Fire Inspector. Telephone number is 843-740-2617. Fax number is 843-745-1002. A copy of this plan must be forwarded to your Event Coordinator.
9. Vehicles on display within an exposition facility shall comply with NFPA 101 Life Safety Code 12.7.4.4 Vehicles:
 - a. All fuel tank openings shall be locked and sealed in an approved manner to prevent the escape of vapors; fuel tanks shall not contain in excess of one-half their capacity or contain in excess of 38 L (10 gal) of fuel, whichever is less.
 - b. At least one battery cable shall be removed from the batteries used to start the vehicle engine, and the disconnected battery cable shall then be taped.
 - c. Batteries used to power auxiliary equipment shall be permitted to be kept in service.
 - d. Fueling or defueling of vehicles shall be prohibited.
 - e. Vehicles shall not be moved during exhibit hours.
10. If a compressed natural gas (CNG) powered vehicle is parked inside a place of assembly, the following conditions must be met:
 - a. Close shutoff valve or valve outlet of CNG vehicle container and operate engine until it stops. The valve must remain closed while the vehicle remains indoors.
 - b. At least one battery cable must be disconnected from the battery used to start the vehicle engine and taped to prevent contact with the battery terminal.
11. If the floor space is occupied by tables, chairs or other movable furniture, aisles with at least 36 inches of clear width must be maintained to provide ready access to exit doorways.

12. Fire extinguishers must remain accessible and unobstructed.
13. The use and display of untreated cut Christmas trees are prohibited.
14. LP gas containers having a maximum water capacity of 12 lb. (Nominal 5 lb. LP Gas capacity) may be permitted for temporary use inside the Facilities for public exhibitions or demonstrations. If more than one such container is located in the same room, the containers must be separated by at least 20 feet. All tank cylinders must be secured.
15. Empty combustible containers (cardboard boxes, etc.) cannot be stored in or behind the booth. No more than 2,500 cu. ft. gross volume of combustible empty packing cases, boxes or barrels can be stored in any building.
16. Pyrotechnics will not be used unless a proper permit is obtained. The permit application can be obtained from the Facilities. **Permits must be obtained 45 days prior to the show.**

8.0 FOOD & BEVERAGE

Centerplate

8.1 EXCLUSIVE SERVICES

1. Centerplate is the exclusive provider of food and beverage service at the North Charleston Coliseum, North Charleston Performing Arts Center and the Charleston Area Convention Center Exhibit Halls, hereon referred to by Centerplate as the Facilities.
2. Food and beverage service includes, but is not limited to, the sale of beverages (alcoholic or otherwise) and food items.
2. In order for a Booth Food Permit to be issued, exact descriptions of sample and portion size must be submitted to Centerplate at least 21 days prior to the opening of the event. Exhibitors may sample only merchandise that they produce in the ordinary course of their business and must not be in competition with products or services offered by Centerplate. Exhibitor must sign a Hold Harmless Agreement, indemnifying Centerplate, SMG and the City of North Charleston from any claims for injury or illness that may arise from said activity. Said exhibitors must supply proper liability insurance.

8.2 MENUS & FOOD

1. Centerplate must be provided exact menu selections, meeting requirements and estimated number of patrons no later than 21 days prior to the first rental date. Exact number of guaranteed patrons must be given to Centerplate 3 working days prior to the event. Centerplate will prepare 5% over the guaranteed number.
2. No food or beverages will be brought in to the Facilities unless purchased from Centerplate (unless otherwise agreed in writing).
3. Due to insurance regulations, no leftover food or beverages can be taken from the premises. At the conclusion of the function such food becomes the property of Centerplate. When appropriate, left over food is donated to local area shelters.
3. It is the Show Manager's responsibility to distribute Booth Food Permit Applications and Hold Harmless Agreements (see attachments) to Exhibitors. Completed Applications along with an executed Hold Harmless Agreement and Insurance Certificate should be turned into Centerplate by the Show Manager no less than 21 days prior to the event.
4. Booth Food Permits will not be issued for the distribution of alcoholic beverages.
5. When a Booth Food Permit is issued, exhibitors may distribute food samples in the authorized space only. Samples are limited to 2 ounces of non-alcoholic beverages and food items.

8.3 SAMPLING GUIDELINES

1. Exhibitors or groups are not allowed to sell, give away or distribute samples of any food or beverage items without written permission from SMG and Centerplate. Upon agreement of all parties, a Booth Food Permit may be issued.
6. Exhibitors having the need to distribute food/beverage samples not relevant to their business or manufacturing will order these items from Centerplate.

8.4 ALCOHOLIC BEVERAGES

1. Centerplate follows and strictly adheres to the Alcoholic Beverage Laws established by the State of South Carolina.
2. Bringing alcoholic beverages into the Facilities is prohibited unless purchased from Centerplate or as otherwise agreed in writing.
3. Centerplate reserves the right, in its sole discretion, to suspend alcoholic beverage sales at any time during your event.
4. If Centerplate's Alcohol Licenses are suspended or revoked in whole or in part, or Centerplate is fined or otherwise sanctioned, because of an act or omission of customer, an exhibitor of customer, or an employee, agent, officer, licensee, guest, patron or invitee of customer or exhibitor of customer, customer must indemnify Centerplate for all claims, losses, damages and expenses, including reasonable attorneys' fees, incurred by the Centerplate due to such suspension, revocation, fine or sanction.

8.5 HOSPITALITY CATERING

1. All hospitality catering must be arranged with and purchased from Centerplate. You or your event participants will not bring food, beverages and/or alcoholic beverages in the facility for hospitality purposes.

8.6 CONCESSION STANDS

1. Concession stands are available to be open for your event. Please contact Centerplate at least 45 days prior to the event for this service.

8.7 FYI

If you have any questions or concerns about the above-outlined policies or any other food and beverage-related issue, please contact Centerplate - North Charleston Facilities' General Manager at (843) 744-0168.

9.0 DIRECTIONS

For questions regarding the applicable rates and rules, please contact: **Facility Parking - (843) 554-3887**

The Coliseum/Convention Center area is located between International Blvd and Montague Avenue at Interstate 526 in North Charleston. Below are directions traveling from the South, North, East and West.

When traveling from the South (Coming from Savannah/Hilton Head Area):

Take Interstate 95 North to Hwy 17 North (to Charleston). Follow Hwy 17 North to Interstate 526 East (to North Charleston.). Take the Montague Avenue exit off of I-526. If you are attending an event at the **Coliseum or Performing Arts Center**, at the bottom of the ramp, turn right onto Montague Avenue, the Coliseum and PAC are located on your left. If you are attending an event at the **Convention Center**, at the bottom of the ramp, go straight through the traffic light. At the next light, turn right onto International Blvd, the Convention Center is located on your right.

When traveling from the North (Coming from Myrtle Beach/Georgetown Area):

Take Hwy 17 South to Interstate 526 West (to North Charleston). Follow I-526 past the I-526/I-26 Interchange. Take the first exit past the Interchange for International Blvd, Montague Avenue, and Charleston Int'l Airport. If you are attending an event at the **Coliseum or Performing Arts Center**, at the bottom of the ramp, go straight through the traffic light, following the signs for Montague Avenue. At the next light, turn left onto Montague Avenue, the Coliseum and PAC are located on your left. If you are attending an event at the **Convention Center**, at the bottom of the ramp, turn left onto International Blvd, and the Convention Center is located on your right.

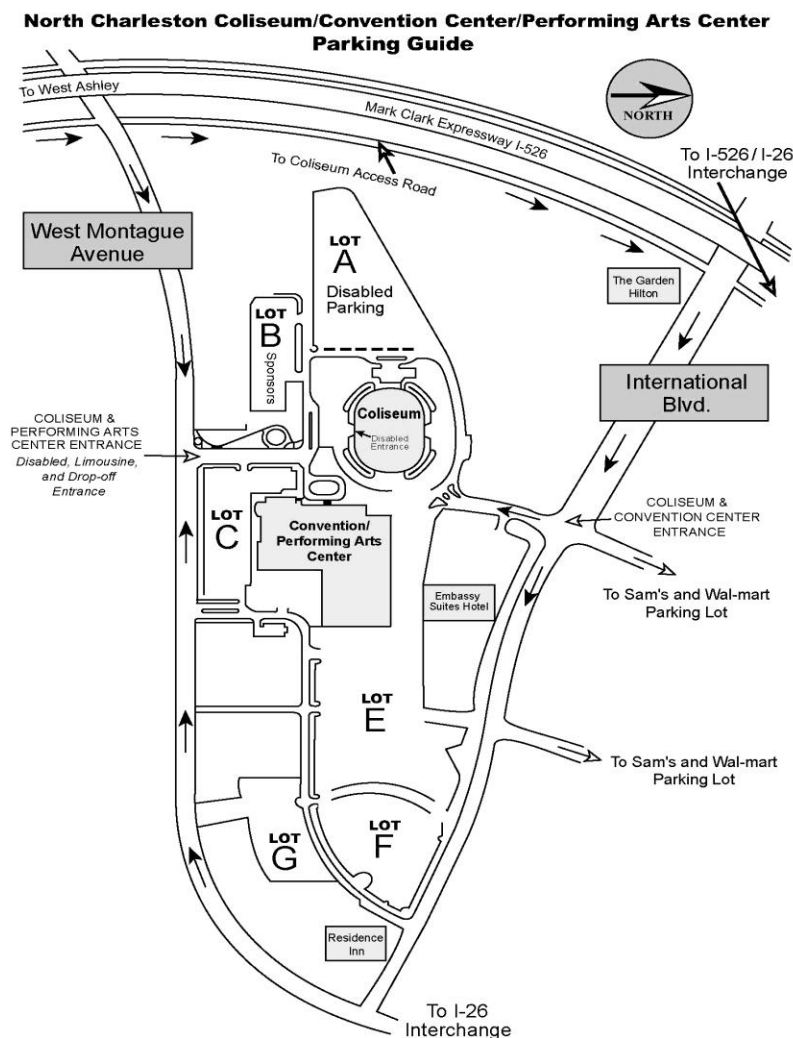

When traveling from the West (Coming from Greenville/Columbia area):

Follow Interstate 26 East to Exit 212B (I-526 West, Savannah/Airport). Take the first exit off of I-526 (for International Blvd, Montague Avenue, and Charleston Int'l Airport.) If you are attending an event at the **Coliseum or Performing Arts Center**, at the bottom of the ramp, go straight through the traffic light, following the signs for Montague Avenue. At the next light, turn left onto International Blvd, the Coliseum and PAC are located on your left. If you are attending an event at the **Convention Center**, at the bottom of the ramp, turn left onto International Blvd, and the Convention Center is located on your right.

When traveling from the East (Coming from Downtown Charleston area):

Follow Interstate 26 West to Exit 213 (Montague Avenue). Turn left onto Montague Avenue. If you are attending an event at the **Coliseum or Performing Arts Center**, follow Montague Avenue past International Blvd, the Coliseum and PAC entrance is located on your right. If you are attending an event at the **Convention Center**, follow Montague Avenue to International Blvd; turn right onto International Blvd. The Convention Center is located on your left.

10.0 SERVICE CONTACTS

(All Area Codes are 843 unless noted)

Audio/Visual Rentals:

AV Connections	529-1449
PDA Lighting - Sound - Special Effects	554-3466
Presentation Services AV	577-9185

Bus Repair and Rental:

Great American.....	824-2727
Sea Island Stages	767-4310

Catering:

Centerplate Catering	744-0168
Embassy Suites Charleston Convention Center	747-1882

Chiropractor:

Ross Family Chiropractic.....	766-4444
Dr. Norman Bishop – Trident Family Chiro.....	764-3663
Dr. Jon Etheridge – Advanced Medical Assoc.	875-4132
Carolina Chiropractor Peninsular Chiro.....	723-6475

Dentist:

Dr. Jack Condrey	552-1600
Dr. Mike Engel	571-3560

EMT:

American Heritage Ambulance.....	824-5225
Carolina Medicare.....	767-9997

Fire Department:

Chief Fire Inspector Cindy Killete.....	740-2617
---	----------

Formalwear:

Sarvi Formalwear	553-8470
------------------------	----------

Furniture Rental:

FSI	747-5223
-----------	----------

Golf:

The Golf Club at Westcott Plantation	(866) 211-4653 / 871-2135
--	---------------------------

Hospitals:

Bon Secours St. Francis Xavier Hospital	402-1000
Charleston Trident Medical Center	797-7000
East Cooper Regional Medical Center	881-0100
Medical University of South Carolina	792-2300
Roper Hospital	724-2000

Hotels & Motels (local):

Embassy Suites Charleston Convention Center.....	747-1882
aloft Charleston Airport & Convention Center.....	566-7300
Charleston Marriott Hotel.....	723-3000
Charleston Place Hotel	722-4900
Courtyard by Marriott North Charleston	747-9122
Days Inn Airport/Coliseum	747-4101
Embassy Suites Historic District	723-6900
Francis Marion Hotel	722-0600
Hampton Inn Airport.....	554-7154
Hampton Inn Daniel Island	216-6555
Hampton Inn & Suites West Ashley.....	573-1200
Hilton Garden Inn Charleston Airport.....	308-9330
Holiday Inn Charleston Airport & Convention Center.....	576-0300
Holiday Inn Charleston Riverview	556-7100
Holiday Inn Express Hotel & Suites North Charleston	553-1600
Homewood Suites by Hilton	735-5001
Kiawah Island Golf Resort / The Sanctuary at Kiawah Island	768-2121
The Mills House Hotel	577-2400
North Charleston Inn.....	744-8281
Planters Inn	722-2345
Quality Suites Convention Center	747-7300
Radisson Inn Charleston Airport.....	744-2501
Ramada Hotel Charleston Airport	572-2200
Residence by Marriott Charleston Airport.....	266-3434
Sheraton North Charleston	747-1900
Sleep Inn Mt. Pleasant.....	856-5000
Sleep Inn North Charleston	572-8400
Wild Dunes Resort	886-6000
Wingate Inn.....	308-9666
Wingate Inn University Blvd.....	553-4444
Woodlands Resort & Inn.....	875-2600

Licenses:

City of North Charleston Business License office.....	740-2634
---	----------

Limousine:

Absolutely Charleston	747-4448
Charleston Executive.....	(888) 309-7779 / 746-9000
Royal Limousine	884-7272

Laundry:

Old Towne Cleaners (dry cleaning).....	744-8822
Evanston Coin Laundry (wash/dry only).....	767-0131
Century Cleaners (dry cleaning & laundry).....	553-4621

Massage Therapist:

Jo Ann McDaniel	270-2027
Charleston Therapeutic Massage.....	723-7005
Billy Rampey.....	729-0463

Music Stores:

Fox Music House 740-7200

Photographer:

Rick Rhodes Photography 766-7425

Physician - ENT

Dr. C.W. Schwenzfeier 763-0543

Dr. Russell Kitch 863-1188

Piano Rental and Tuning:

Fox Music House 740-7200

John Eisenhart 552-2021

Joe Malecki 853-8443

Plants/Flowers:

Frederick Florist 744-8631

McGrath's Ivy League Florist 554-8774

Nancy's Exotic Plants 556-9299

The Flower Cottage 577-6224

Record/Tapes/CD Stores:

Monster Music & Movies 571-4657

Rigging Supplies:

Charleston's Rigging & Marine Hardware, Inc. 723-7145

Security Services:

North Charleston Police Department (Deputy Chief Barfield) 740-2850

United Event Services, Inc. (Mike Kahaly) (803) 929-1133

Stage Equipment:

GP Sound 559-0150

High Output, Inc. 722-3600

NBS 722-7507

Production Design Associates 554-3466

Trade Show Decorating:

George Fern Co. (Charlotte Office) (704) 398-7440

Displays Unlimited (803) 926-5300

Blue Chip Expo (843) 681-4545

Van/Truck/Auto Rental:

Avis (Airport) (800) 230-4898 / 767-7030

Budget (Airport) 767-7051

Enterprise (Airport) 767-1109

Jones Ford 744-3311

Thrifty (Airport) 552-1400

11.0 FACILITY DIAGRAM

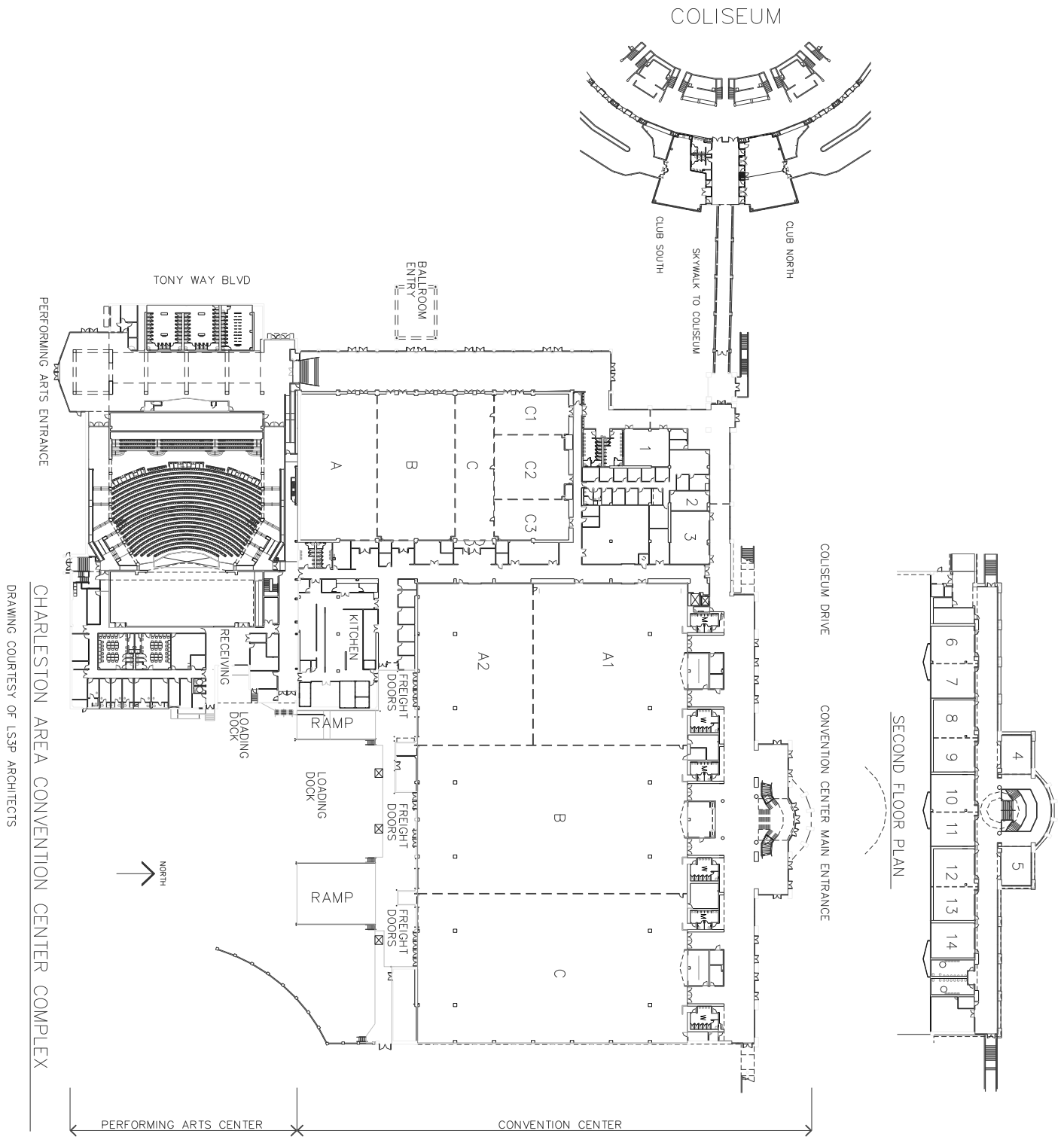

12.0 EXHIBITOR FOOD BOOTH PERMIT APPLICATION

Show: _____

Date: From _____ To _____

Exhibitor: _____

Contact Person: _____

Address: _____

City/State/Zip: _____

Phone Number: _____

Fax Number: _____

Items to be sampled	Size

Show Manager

Circle one

Approved

Not Approved

Signature: _____

Print Name: _____

Centerplate

Circle one

Approved

Not Approved

Signature: _____

Print Name: _____

Food Booth Permit Application **due from Exhibitor to Show Manager 30 days prior to first day of show.**

Food Booth Permit Application **due from Show Manager to Centerplate 21 days prior to first day of show.**

Food Booth Permits **will be issued to Show Manager by Centerplate 14 days prior to show.**

Centerplate

North Charleston Coliseum • Performing Arts Center • Charleston Area Convention Center

5001 Coliseum Drive

North Charleston, SC 29418

(843) 744-0168 • Fax (843) 566-1731

Exhibitor Food Booth Permit Hold Harmless Agreement

Notwithstanding the issuance of a Food Booth Permit by Centerplate, Exhibitor understands and acknowledges that Centerplate has no responsibility for the quality, preparation or storage of any beverages or food product to be sampled or dispensed by Exhibitor. Exhibitor must comply with all laws, rules and regulations applicable to the purchase, storage, preparation and dispensing of the beverages and food products covered by this permit. Exhibitor shall indemnify, defend and hold Centerplate and the City of North Charleston and their respective officers, owners, directors, employees, agents and affiliates harmless from and against any and all suits, claims, liabilities, judgments expenses (including attorney's fees and court costs), damages or losses, arising from the sampling, preparation, storage or dispensing of beverages and/or food products under the permit or at the show.

Exhibitor Name: _____

Address: _____

Signature: _____

Print Name: _____

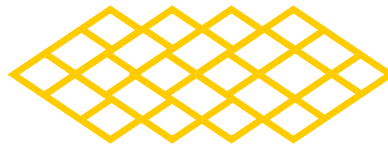

CHARLESTON AREA CONVENTION CENTER

R. Keith Summey
Mayor

David R. Holscher
General Manager

13.0 MARQUEE MESSAGE REQUEST FORM

Form is due 14 days prior to the first date of your event

Name of event:	
Date of event:	
Event website:	
Contact name:	
Contact phone:	
Contact email:	
Run dates requested:*	<i>*We reserve the right to schedule all final run dates.</i>

MAIN MARQUEE MESSAGE (272x128 pixels)

Option 1: Create your own artwork

Art must be no larger than 272x128 pixels, and must be saved in a jpg format; email to address listed below.

Option 2: We create the artwork for you

If you have a logo or picture, please email it to us along with this form and we will do our best to put this in the message. No more than one picture/logo will be used for one message. In addition, we will list the event name (unless included in logo) and date(s) of event. We will also list your event website when possible. Space is limited, so we prefer to keep the copy to a minimum in order to ensure motorists are able to read marquee messages.

*If your event is private, then please list a special message below. Please limit to 20-25 characters (ex. *Welcome Gymnasts!* **OR** *Thank You to our Sponsors*)

Message: _____

SMALL MARQUEE MESSAGE (128x32 pixels)

We will create this message. Due to very limited space, the only information listed will be the event name and date(s).

Email form to mcrowley@northcharlestoncoliseum.org

Or

Return form to address or fax below, Attn: Melanie Crowley

5001 Coliseum Drive - North Charleston, SC 29418 ♦ PH: (843) 529-5050 FAX: (843) 529-5010

www.northcharlestoncoliseum.org ♦ www.charlestonconvention.com